

CALORIFIERS

PREMIUM QUALITY COMMERCIAL,
INDUSTRIAL AND MARINE CALORIFIERS



SOLAR & HEATPUMP UNITS AVAILABLE



McDonald
Water Storage

Hot Water Storage Solutions

McDonald Water Storage manufacture a wide range of Calorifiers to suit Vented and Unvented Installations and are widely recognised as the specialists in renewable energy calorifiers.

The growth in demand for Copper calorifiers is largely thanks to coppers' enhanced thermal conductivity, as well as its excellent non-corrosive and anti-bacterial qualities. These are proven to be more effective at eradicating germs such as MRSA, E-coli and Legionella.

Quality is paramount and every McDonald Water Storage Calorifier is manufactured to BS853 and follows a BSI approved quality plan to ISO 9002. Each unit is rigorously tested to ensure problem free installation and operation.

Other materials are available on request.

Sizing and technical advice are readily available to ensure each unit is suitable for the capacity and pressure required. Design sketches are also available for individual projects. We carry a wide range of sheets, spinings and other materials. This helps us to provide a rapid delivery often within one week.

THE ADVANTAGES OF COPPER

- Tried and tested material
- Proven to be healthy and safe
- Long-Lasting
- 100% Recyclable, benefiting the environment



CALORIFIER TYPES

VERTICAL - Mounted on steel or copper ring stand or legs as required.

HORIZONTAL - can be supplied with support cradles to suit.

DIRECT - Electrically Heated by Immersion Heater.

INDIRECT - Heated By Boiler, Heat Pump or similar.

BUFFER VESSELS - Providing additional storage for secondary or primary water.

RENEWABLES - All units can be manufactured to suit renewable input, such as Solar or Heat Pumps. Copper is the ideal material to maximise the gains from the lower temperatures often involved.

MARINE CALORIFIERS - A wide range of options and sizes are available. This coupled with a rapid availability - often required where refits and repairs need a quick turnaround.

BESPOKE CALORIFIERS

We have an enviable position in the market for ability to design, manufacture and supply some of the most complex and technical calorifiers thanks to our inhouse expertise and our advanced machining capabilities. Whether its sizing, multi-fuel applications or connections, our team are only too happy to help. This enables you to get exactly what your project requires without compromising on any aspect.

PRIMARY HEATERS

Indirect units can have either a Fixed Coil or a removable 'U' Tube Battery, both suitable for Water or Steam. Fixed Coil types are more economical and an access manhole can be added if access is required for maintenance.



CALORIFIER OPTIONS

Thermal Insulation

Polyurethane Foam Lagging is most economical but Rockwool insulation with a Galvanised Steel case is also available for a more aesthetically pleasing finish.

Rapid Recovery

State the re-heat time required and what kW input is available and a Primary heater will be designed to suit.

Immersion Heaters

Calorifiers are as standard supplied with 2¼" Immersion bosses and Immersions can be supplied with up to 18kW to fit these. Flanges can be fitted to take more highly rated Immersions, which we are also able to supply.

Control Panels are also available.

De-stratification Pumps

These can be fitted with the appropriate internal pipework to suit. These eliminate the risk of legionella.

Inspection Openings

Allowing access for inspection or cleaning.

Gauges, safety valves, lifting lugs etc.

A complete range of gauges and valves are available on request.



Plate Heat Exchangers

These can be linked to Calorifiers for high peak demand. See our separate brochure.

DIMENSIONS* (GENERAL GUIDE)

Capacity	Shell Size	Capacity	Shell Size
450 litres	1800 x 600mm	1500 litres	2000 x 1050mm
500 litres	2000 x 600mm	1800 litres	2400 x 1050mm
550 litres	2200 x 600mm	1800 litres	1750 x 1200mm
600 litres	1800 x 675mm	2000 litres	2500 x 1050mm
700 litres	2150 x 675mm	2000 litres	1950 x 1200mm
700 litres	1700 x 750mm	2500 litres	2450 x 1200mm
800 litres	1950 x 750mm	2500 litres	1900 x 1350mm
900 litres	2200 x 750mm	3000 litres	2900 x 1200mm
1000 litres	2200 x 800mm	3000 litres	2300 x 1350mm
1000 litres	1750 x 900mm	3500 litres	2700 x 1350mm
1200 litres	2050 x 900mm	4000 litres	3050 x 1350mm
1500 litres	2500 x 900mm		

***THIS IS A GENERAL GUIDE OTHER OPTIONS AVAILABLE - CONTACT 01592 611123**

Customer

Reference

Date

Tel

Fax

Email

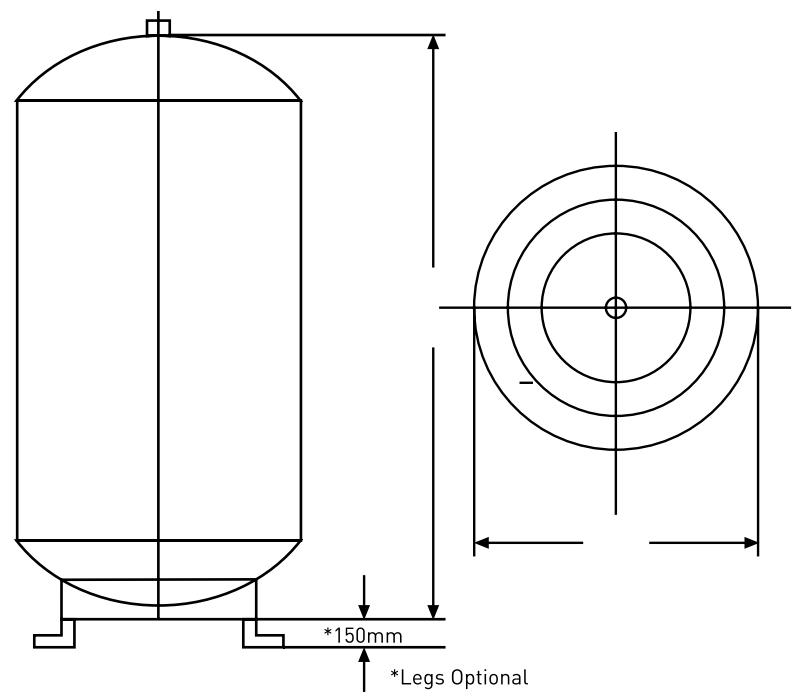

CONNECTION SIZES

1. Primary Flow
2. Primary Return
3. Secondary Feed
4. Secondary Flow
5. Secondary Return
6. Drain
7. Thermostat/s
8. Thermometer
9. Safety Valve
10. Altitude Gauge
11. Anti Vacuum
12. Bursting Disc
13. Immersion Heater
14. Inspection Opening
15. De-Strat Pump

ANCILLIARY EQUIPMENT

Safety Valve

Dial Thermometer

Dial Altitude Gauge

Anti Vacuum Valve

De-Stratification Pump

Immersion Heater and Supply
(Phase)

Insulation Type

(Foam Lagged Or Clad)

WHEN ORDERING/SPECIFYING PLEASE STATE:

1. Quantity required
2. Type - Vertical or Horizontal
3. Dimensions or Capacity required
4. Vented or Unvented
5. Working Pressure of Secondary System
6. Working Pressure of Primary System
7. Direct or Indirect
8. Coil Type or U-Tube Battery Type
9. Pumped or Gravity Fed Primary circuit
10. Recovery Time required
11. Primary Medium
12. Primary Temperature
13. Ring-stand or legs. Cradles if Horizontal
14. Manhole details if required
15. De-stratification pump required

FAX TO 01592 611166